

# your

Issue No. 3

Like us on   @ChesterfieldBC

Spring 2014

# Chesterfield

## Putting our communities first

News and views from Chesterfield Borough Council

[www.chesterfield.gov.uk](http://www.chesterfield.gov.uk)

**Buoyant  
news...  
page 3**



# Welcome

We all need a bit of cheer at the moment so I am pleased to tell you we are freezing council tax to help hard pressed tax payers in Chesterfield.

At the same time we are delivering on our key priorities and residents, questioned as part of a national survey, say they are happy with the services they are receiving.

The new market hall is doing really well, with more people coming through the door and nearly every unit and office space now let. That is a real achievement in tough economic times and led to it being officially named the UK's best small indoor market.

We've also received a national award - Placemaking Team of the Year – that recognises the work our regeneration team, working in partnership with Destination Chesterfield, has done to regenerate the town and create new jobs.

But I wouldn't want to make out everything is rosy in the garden. As you will see on pages four and five we have had to make some tough decisions.

While the UK economy shows signs of picking up the worst impacts of the Government cuts to the funding of local councils will come in the next three years.

Our focus is to grow the economy, protect as many frontline services and jobs as possible, and deliver value for money services. But we - or any council - cannot continue to do all the things residents have relied upon us to do in the past.

**Councillor John Burrows**  
Leader of Chesterfield Borough  
Council

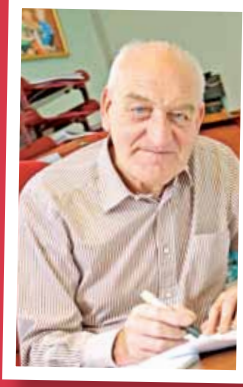

## Get in touch

**We are always keen to hear your comments about Your Chesterfield.**

Email: [john.fern@chesterfield.gov.uk](mailto:john.fern@chesterfield.gov.uk)  
Ring: 01246 345245.

Published by Chesterfield Borough Council, Town Hall, Rose Hill, Chesterfield, Derbyshire, S40 1LP

### Get the latest news

Follow us on

Twitter @ChesterfieldBC

Like us on Facebook

Website: [www.chesterfield.gov.uk](http://www.chesterfield.gov.uk)

## Are we accessible to you?

### If not ask us how we can help.

We want everyone to be able to read and understand our publications.

We want everyone to be able to contact us.

#### On request we will provide free of charge:

- Language interpreters, including for sign language.
- Translation of written material into other languages.
- Material in braille, large print and recorded onto CD.

کیا ہم تک آپ کی رسائی ہے؟ اگر نہیں تو ہمیں بتائیے!

你可覺得易於與我們接觸？若不的話，請提出要求。

Czy łatwo jest skontaktować się z nami? Jeżeli nie, powiedz nam o tym!

#### Please contact us:

**General enquiries:**

**01246 345345**

**Text:**

**07960 910264**

**Website:**

**[www.chesterfield.gov.uk](http://www.chesterfield.gov.uk)**

**Email:**

**[info@chesterfield.gov.uk](mailto:info@chesterfield.gov.uk)**

**Fax:**

**01246 345252**

# Are you being served?

**A recent survey of residents shows more of you are satisfied with the services we deliver.**

The survey, called Are you being served?, is part of a national scheme for local councils to gauge how pleased residents are with their services and will allow us to measure the results against other councils.

The survey was sent to a random sample of 3,000 people in the borough, of which 73.8 per cent said they are satisfied with the way we run our services – compared to 47.8 per cent in a similar survey carried out in 2008.

During the recession, we have been forced to make savings but 54.6 per cent of you felt council services provide value for money, compared to 37 per cent in 2008.

The only area where we saw the figures worsen was the number of people reporting problems with noisy neighbours or loud parties, up to 13.3 per cent from 12.6 per cent six years ago.

**Most of the services we offer were praised in the survey:**

**59.7 per cent** feel well informed about council services.

**90.5 per cent** were satisfied with the bin collections



**85.5 per cent** were happy with kerbside recycling



**61.9 per cent** said they were satisfied with how clean the streets are



**63.6 per cent** of people were happy with the facilities on offer at the Healthy Living Centre, Staveley and **60.4 per cent** were satisfied with Queen's Park Sports Centre



The Winding Wheel and the Pomegranate Theatre fared well with **84.3 per cent** and **83.5 per cent** respectively saying they were happy with the services there.



Natalie Ellis, pictured left and on the front cover with her seven-month-old daughter Eva, is one of the happy customers at the Healthy Living Centre that was praised in the survey.

She said: "I use the gym and do the classes and swimming myself and I have just enrolled Eva to do swimming as well.

"The centre is 10 minutes from where I live and is nice because it has everything I need under one roof. I enjoy going and it is always pleasant and friendly."

# Council tax freeze delivered despite cuts

**We have decided to freeze council tax for Chesterfield Borough Council services to help hard pressed residents.**

This is despite us facing the biggest spending power reduction of any council in England – a cut of 6.9 per cent – while some local authorities in the South are getting spending power increases.

In 2014/15 we have to make a further £1 million of reductions and this has meant taking some tough decisions.

While this will be our biggest challenge yet, we have already made considerable savings without many residents probably realising. Since the Coalition Government came to power in 2010 we have made £2.4 million of savings - a 27.5 per cent cut – without major impacts on front line services or large scale job losses.

We did this by reviewing the way services are run to make them more efficient and responsive to customer needs. For example, our leisure services staff have so far saved £400,000 by fundamentally changing the way they deliver services and achieving customer service improvements at the same time.

At the heart of these improvements and changes has been greater and better use of IT to streamline processes.

But while the UK economy is beginning to pick up councils, including ourselves, face the worst of the cuts in the coming years.

In 2010/11 we received an £8.7 million grant from the Government but in 2014/15 that will fall to £6.3 million before dropping to £5.3 million in 2015/16 and £4.3 million in 2016/17.

So while we will continue to find efficiencies all the easy wins have now been made. The scale of the cuts we face is so large that any decisions we take will have a direct impact on the service you receive as residents.

To achieve the necessary savings in 2014/15 it is planned to:

- Carry out restructures and efficiency reviews of many of the council's Town Hall based back office services but also the council's theatres, CCTV, museum

and grounds maintenance services to make savings of £350,700

- Consider charging for entry to the annual fireworks display to reduce the costs by £10,000
- Cancel the community arts festival and reduce spending on all other festivals and events, including the Christmas lights, to save £30,500
- Cut grants to partner organisations and community groups by £30,500, with the community groups instead being invited to apply for Community Chest funding
- Seek voluntary redundancies or voluntary early retirements to save £250,000
- Review the terms and conditions of staff to save £100,000
- Not fill some vacant posts to save £86,600
- Generate additional income at our sports centres and theatres and increase charges for services such as pest control and cemeteries.

**The council has also agreed a new Corporate Plan - a document that sets out the priorities we will spend money on.**

It has three priorities to deliver our vision of 'putting our communities first'.

They are:

- To make Chesterfield a thriving borough - which brings together a range of aims designed to grow the local economy and create jobs
- To improve the quality of life for local people - which is about continuing to provide those services that most impact on people's lives
- To provide value for money services - which aims to find ways of designing our services to best meet customer needs while delivering them in more efficient ways, particularly through greater use of IT.

Our staff will work to achieve our vision by being:

- Customer focused: delivering great customer service, meeting customer needs
- Can do: striving to make a difference by adopting a positive attitude
- One council, one team: proud of what we do, working together for the greater good
- Honesty and respect: embracing diversity and treating everyone fairly

**Although Chesterfield Borough Council sends out council tax bills to its residents only 10 per cent of the total amount paid goes to the council.**

**The rest is collected on behalf of different authorities with:**

- **74 per cent of the total bill going to Derbyshire County Council to pay for services including education, roads and social services**
- **11 per cent going to Derbyshire Police**
- **5 per cent going to Derbyshire Fire and Rescue**

**Each of these authorities sets their own levels of council tax that come together to form the final bill.**

**Turn to the back page to see what your council tax is used to pay for.**

# Improvements for Chesterfield Theatres



Chesterfield's theatre-goers will benefit from a series of improvements that will be carried out at both our theatres from this spring.



Both the Pomegranate Theatre and the Winding Wheel are owned and run by Chesterfield Borough Council.

We have secured a grant of £495,000 from Arts Council England towards the work and the council is paying £250,000.

Work will begin at the Winding Wheel in April and is expected to last until June. Here, improvements will be carried out to:

- The auditorium, stage and backstage areas to allow the venue to attract more high

quality productions, following the success of West End touring productions including Dreamboats and Petticoats, Blood Brothers and Joseph and the Amazing Technicolor Dreamcoat

- The auditorium, to allow it to be used for more activities and studio performances
- Better access for artistes with impaired mobility.

Work is planned to take place at the Pomegranate Theatre between July and August. This will see:

- Seating in the stalls renewed
- More seats added in the auditorium
- New digital cinema equipment added to give better quality for the regular film performances on offer,



as well as broadcasting live performances of productions from across the world.

The work has been planned to cause as little disruption as possible with at least one theatre remaining open for live performances, hires and events while the work is carried out on the other.

We would also like to improve the standards at both theatres further for our audiences by making improvements to the foyers, bars, lifts, toilets and seating.



To fund this, we have introduced a theatre refurbishment levy.

This means that a charge of £1.50 will be added to each ticket for council promoted professional events at both the Pomegranate Theatre and the Winding Wheel. This does not apply to amateur, community and charity events.

The money will be put aside to fund the improvements and safeguard the future of both our venues.

The prices in the current brochure include the new levy.

Mike Spriggs, from the Chesterfield Theatre Friends, says: "We welcome any work undertaken that will help enhance the theatre-going public's enjoyment of live theatre in Chesterfield.

"We will continue to raise funds to supplement this investment and promote the Pomegranate Theatre and the Winding Wheel."

## Pomegranate Theatre

The Pomegranate Theatre currently seats 545 people.

The theatre is housed – along with Chesterfield Museum – in the Grade II listed Stephenson Memorial Hall, built in 1879 as a tribute to the railway pioneer, George Stephenson, who lived in Chesterfield.

It became the UK's first civic theatre in 1949 and celebrates its 65th anniversary this year with a series of special events in the autumn.

It was renamed the Pomegranate Theatre in 1982 in a public competition. The pomegranate is a symbol on the borough's coat of arms and can be seen represented in the auditorium.



*Winding Wheel ballroom showing the beautiful ornamental skylight*

## Winding Wheel

The Winding Wheel is a Grade II listed building, originally built as a cinema, called The Picture House, in 1923. The building was extended in 1930, adding a large ballroom and extra seating.

The cinema closed in 1981 and was bought by Chesterfield Borough Council in 1987.

The venue hosts a wide variety of events including elaborate stage shows, political conferences, wedding receptions, banquets and has been used for TV programmes.



# Project round up

One of our aims is to help deliver regeneration projects that make the borough a better place. Here is a look at how some of these projects are progressing.

## Chesterfield Waterside

The Chesterfield Waterside development is a £340 million scheme ranked 47th in the top UK regeneration projects.

When complete the scheme will create 30,000 sq m of commercial space and 1,500 homes.

Planning permission has been granted for the first phase of residential development and work should start on building 19 affordable homes this spring.

Significant private sector interest is also being shown in the commercial canal basin area of the scheme.

Loan funding of £3.1 million has been secured from the Growing Places Fund through the Sheffield City Region and D2N2 Local Enterprise Partnerships to build a new canal link and complete environmental improvements around the canal basin. Once finished, this will enable the first phase of commercial development to start and further phases of housing development.

We expect work on the canal link to start by this autumn.

*Artist impressions of the Waterside scheme are shown below and top right.*

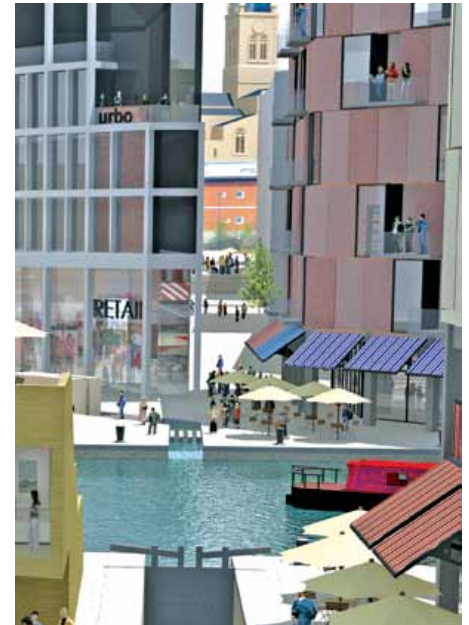

## Northern Gateway

The Northern Gateway project is one of the town centre's major regeneration projects, centred on the Donut roundabout site.

Plans to create a new high quality shopping, restaurant and leisure development on this land were unveiled at exhibitions in 2012.

However, the closure of the Co-op and changing shopping patterns are likely to force a rethink of the plans.

The council remains committed to delivering redevelopment of the northern side of the town centre and improving the quality of the shopping and visitor offer, but redevelopment work is unlikely to start on site in 2014.





Artist impression of the inner open air section of the Northern Gateway development

## Chesterfield Market Hall

We recently completed a £4.3 million refurbishment of Chesterfield's grade II listed Market Hall, at the heart of the town's historic market.

Funded with the help of European Regional Development Fund and Heritage Lottery Fund money, it re-opened in October 2013.

New traders include New Dawn (shown top right), offering interior design; The Repair Centre (mobile phones - centre photo),



offering mobile phone repairs; the Market Gallery, selling glass sculptures and Lambs Cupcakes of Chesterfield.



**If you are interested in a new retail unit, contact Claire Cunningham on 01246 345255.**



Interior view of the Market Hall.

## Housing developments

Work is ongoing to build more than 200 new homes in the borough.

Barratt Homes has now completed around three quarters of the new homes at Saltergate, on the former Chesterfield Football Club site, with 16 per cent sold to first time buyers. They expect to complete the site by the summer.

Miller Homes is building 127 homes on the site of the former Chesterfield Panthers Rugby Club as part of the Portlands development, on Sheffield Road.

The site has two, three and four bedroom properties for sale. They have energy saving features and many are fitted with bat bricks and external bird boxes to help wildlife.

And Chesterfield Borough Council and Derbyshire County Council are also in negotiation with a well known developer to sell the former Newbold School site for housing.



# You're hired

**With youth unemployment in Chesterfield the second highest in Derbyshire - with 780 young people not in work - it's never been more important to provide opportunities for young people to find work or training.**

The operational services team in our housing service recently took on four new apprentices to learn a variety of skills.

One of the new apprentices is Daniel Curtis, 18. He works for the council for four days each week and spends the other day studying for a national qualification in joinery at Chesterfield College.

He said: "I have always enjoyed joinery and did woodwork at sixth form so when I saw the apprenticeship; I applied for it straight away.

"I wanted to get an apprenticeship because it means you are paid

for the work you do and gives you hands-on experience of learning a trade as well as giving you an idea of what the world of work is like."

Jacob Swallow, 19, recently completed his three-year apprenticeship and is currently working as Daniel's supervisor.

He says: "Being an apprentice has been very enjoyable: I've learned so much more by learning on the job than I would have if I had been studying full-time.

"This has given me the chance to learn the basics of the trade and the health and safety rules you must follow to work under

supervision before gradually being given more and more difficult projects and the opportunity to work on my own."

Sixty per cent of the 136 staff working in the team, based at Stonegravels depot started out as housing apprentices; 99 per cent of apprentices in the housing service go on to permanent jobs with the council.

Our apprenticeship programme is proving a popular choice with young people in the borough, with demand for places as high as 150 applications for each trade.

We currently have 15 apprentices. These include electricians, plumbers, plasterers and joiners.

Daniel Keeton, is in the final year of his apprenticeship.



A plasterer by trade, he is proud of the work he has carried out: "The work gets more and more difficult. With plastering, you only have a small amount of time to work in and, so you are gradually given bigger and bigger walls to cover – making sure you do it in time before the plaster gets too hard."

He said he would recommend an apprenticeship to anyone: "It's been really enjoyable and I've been able to earn money instead of gathering debt by going to university with a job at the end of it."

**“Being an apprentice has been very enjoyable: I’ve learned so much more by learning on the job than I would have if I had been studying full-time.”**

Check our website during June and July for apprentice opportunities starting in September:  
[www.chesterfield.gov.uk/jobs](http://www.chesterfield.gov.uk/jobs)

The number of apprentices in each trade has been planned by identifying future gaps in the service, as current members of staff reach retirement age, meaning that apprentices can be offered a job at the end of their apprenticeship.

This means that skills such as plastering and making doors for properties are kept in-house.



*Inset photograph shows l to r:  
Daniel Curtis, Daniel Keeton and Jacob Swallow*

# Recycle you

**We will soon be making changes to our green bin collections - allowing you to recycle more everyday household items.**

In late spring or early summer, we will ask you to include food waste in your green bin in addition to garden waste.

**When the new collections are in place, please place the following items of food waste in your green bin:**



✓ Fruit, salad and vegetable waste, including peelings, rotting fruit, vegetables etc.



✓ Stale bread, cakes and pastries



✓ Rice, pasta and lentils



✓ Food leftovers



✓ Meat and fish - raw or cooked, including skin and bones



✓ Tea bags and ground coffee.

**We will give every household in the borough with a green bin a free silver kitchen caddy two to three weeks before the new scheme starts.**

This will hold up to five litres of food waste – allowing you to empty your food leftovers into the caddy and empty it into your bin when it is full or when it is convenient for you.

For most people, the caddy will be delivered to your front door. In a few, limited, cases, we will leave the caddy by the back door instead.

**You will still be able to place the following materials into your green bin:**

✓ Garden waste

✓ Grass cuttings

✓ Weeds (not Japanese Knotweed or Ragwort)

✓ Leaves

✓ Flowers

✓ Plants

# r leftovers

- ✓ Pet straw / sawdust (not animal waste)
- ✓ Used compost
- ✓ Bark
- ✓ Hedge clippings
- ✓ Small / thin branches

A leaflet explaining the new collections will be delivered along with the new caddy.

**Please don't do anything until you receive your leaflet.**

The items that you can place in your blue bin will stay the same.

**Here is a reminder of what to put in your blue bin:**

- ✓ Cans/tins
- ✓ Clean aluminium foil
- ✓ Aluminium food trays
- ✓ Metal lids from jars and bottles - please rinse these before placing in the bin
- ✓ Most household plastics, including bottles – please remove tops, these can be put in the bin loose for recycling
- ✓ Yoghurt pots, food trays – please rinse and squash these first - clean plant pots, carrier bags

- ✓ Paper, card and corrugated cardboard
- ✓ Newspapers
- ✓ Magazines
- ✓ Glossy magazines
- ✓ Brochures
- ✓ Shredded paper
- ✓ Catalogues and directories - including Yellow Pages, direct mail
- ✓ Envelopes - please tear out any windows
- ✓ greetings cards and wrapping paper - please remove all tape and plastic

Please place all glass bottles and jars in the caddy inside your blue bin, and make sure they are rinsed out first.

Textiles, such as old clothes, need to go in a plastic sack and be put at the side of the blue bin on collection day, used batteries can go in a clear plastic bag and be tied to the handle of the blue bin on your collection day.

Your black bin is for any waste that cannot be recycled. Please recycle as much as possible by placing recyclable materials in your green or blue bins.

**If you have any enquiries about bin collections, including if your bin collection has been missed or you would like a bulky waste collection, call our refuse team on 01246 345734.**



# Put your best foot forward

After the success of last year's Chesterfield Area Walking Festival, this year's event will take place from **Saturday 10 to Sunday 18 May**.

Walks in this year's festival include: a stroll around the pretty village of Scarcliffe, looking at archaeology on the Hardwick Estate and following in the footsteps of murderers and their victims around Chesterfield town.

There are several different walks available each day during the festival from a moderate stroll to a strenuous 34 mile hike across the hills and trails of Chesterfield.

Most of the walks are free. All are led by a fully-trained guide who will



have information on the history, wildlife and landscape of the area – as well as knowing most of the best cafes to replenish your energy after walking a few miles.

Full details are available on the Chesterfield Area Walking Festival website:

[www.chesterfieldwalkingfestival.co.uk](http://www.chesterfieldwalkingfestival.co.uk)

You can book online to take part in any of the walks.

**For more information, please contact the Chesterfield Visitor Information Centre in Rykneld Square, near the Crooked Spire or call 01246 345777 or 01246 345778.**

## European elections

**Elections to the European Parliament will take place on Thursday 22 May.**

Voting is by the closed list system: to vote, you choose a party – not the individual – on the ballot paper and put a cross next to the party name.

If you are 18 or over and live in the borough, you should be included on the electoral register.

If you need to register, visit: [www.chesterfield.gov.uk/myvote](http://www.chesterfield.gov.uk/myvote) or call our electoral services team on 01246 345243 or 01246 345806.

## Easter fun in our parks

**This Easter, you can take part in a spring treasure hunt in two of our parks while our rangers share their knowledge about the plants and animals of spring.**

The events take place at:

**Holmebrook Valley Park on Thursday 17 April from 1pm to 3pm**

**Poolsbrook Country Park on Tuesday 22 April from 1pm to 3pm.**



They are suitable for children aged four and upwards. It is free to take part but booking is advised as places are limited.

To book, please contact Holmebrook Valley Park on 01246 230731 or Poolsbrook Country Park on 01246 474967.

# Community chest

**More than 30 local groups have received small grants of up to £500 to provide activities for residents since our community assemblies began last September.**

The assemblies have allowed you to choose which good causes in your area should receive funding.

One of these groups was the Friendship Club in New Whittington, who received £200 towards the cost of a Christmas party for members.

Milly Bradley, who has kept the group going for the last 18 years, explained: "Everybody had a good time. There were over a hundred people at our celebration and, in this day and age, to bring the community together is great."

Other groups benefitting include: Loundsley Green Community Trust for new access and facilities at Loundsley Green Community Centre and Hollingwood Bowling Club for new equipment.

## Community Chest

We have set up a new fund for applications: the Community Chest.

We have £40,000 available to support local groups who offer



*Bingo at the Friendship Club, New Whittington with Beryl Dickerson and Doreen Trotman in the foreground*

activities that will improve the quality of life for Chesterfield residents, and are in line with the priorities set by you in each community assembly area. Funding is available for registered charities and community groups with strong links to the borough.

Groups can bid for a minimum of £1,000 and a maximum of £5,000. Funding will be allocated in:

- May 2014 - deadline for applications is 4 April
- November 2014 - deadline for applications is 19 September.

For further information please contact Wendy Blunt, our community development worker on 01246 345344 or e-mail [wendy.blunt@chesterfield.gov.uk](mailto:wendy.blunt@chesterfield.gov.uk)

**The next community assembly meetings will be held from 6.30pm to 8pm on:**

Tuesday 3 June  
**Chesterfield South**  
Hasland Village Hall, Eastwood Park, off Hasland Road

Wednesday 4 June  
**Chesterfield West**  
Loundsley Green Community Centre, Cuttholme Road

Tuesday 10 June  
**Chesterfield East**  
Barrow Hill and Staveley Community Rooms, High Street, Staveley

Wednesday 11 June  
**Chesterfield North**  
The council's Stonegravels depot, Old Brick Works Lane

# Rats on the run



**There are an estimated 1.5 million rats in the UK in and around our homes.**

If you are unlucky enough to have a family of rats in your home – you will know about it and want rid of them as quickly as possible.

Mark Johnson is the council's rat catcher: "My proper title is 'pest control officer' but everyone knows me as the 'rat catcher' or the 'mice catcher' – people remember me coming to their homes and stop me in the street to say hello."

Mark makes between 10 and 12 visits each day to properties across Chesterfield. His first stop is a house in Hady Hill where a small gap in the pipework from outside has allowed rats into the kitchen cupboard.

Mark treats them with a rat poison. He explains: "With older poisons, such as Warfarin - which people often take to thin their blood - it can take several days to kill a rat. More modern poisons can kill a rat with one feed."

His next call is a house in Brimington. The owner is out but the problem is clear: there is bird seed all over the garden.



*Mark puts the poison bait behind the kick boards in the kitchen at Hady Hill.*



*Above: Baiting a rat-run which runs under an old bit of kitchen flooring straight to the source of food from the bird table.*

Mark warns: "Nine out of ten cases of rats are caused by people feeding the birds." Indeed, he calls the fat balls that people leave out in their gardens for our feathered friends – 'rat balls'.



He said: "Rats will move their homes to wherever there is a regular source of food, so keeping food such as this in the garden will encourage rats to move there and feed regularly."

Next is a property with a problem with the drains. Mark explains: "Rats and drains go together."

The property has blocked drain pipes from an old outside toilet – he clears the drain as best he can with hot water and offers to take up the problem with the resident's landlord, who is responsible for organising a permanent repair.

Mark has worked for the council for nearly 30 years and in that

time, he's had lots of satisfied customers.



One of these is Jenny Booth from New Whittington. Both Jenny and her neighbour had a long

standing problem with rats. She explains: "Shortly after buying my house five years ago, I noticed the occasional rat. I stopped feeding the birds in the garden but the rats didn't go away.

"The problem had just moved underground, I could tell when both my neighbour and I heard noises underneath our living room floors.

"Mark came out and suspected the drains – when he lifted the manhole cover, he found a hole in a pipe which had been capped off when a downstairs toilet had been removed. This was then filled with cement to prevent rats getting in the cavity beneath the house.

"Mark is very experienced and he made

sure the problem was resolved quickly – he didn't just put poison down and I've had no further problems."



### From 1 April, new charges will be introduced for pest control

Residents will contribute towards the cost of treating pests as follows:

- £40 for rats, mice, cockroaches and wasps
- £57 for ants
- £67 for fleas
- £98 for bedbugs.

Residents who receive benefits will get their treatments at half price. The cost includes three visits within one month to clear an infestation of rats and mice.

**To report a pest control problem, visit [www.chesterfield.gov.uk](http://www.chesterfield.gov.uk) and click on 'report it' or call 01246 345734 to make an appointment.**

**You can pay for your treatment with a debit or credit card when you book over the phone.**



# Chesterfield's hidden jewel

**Chesterfield's Market Hall reopened after a £4 million redevelopment last October.**



This January saw the Chesterfield Market Hall named as the best small indoor market in the UK by the National Association of British Market Authorities.

They were particularly impressed with the way the project had taken the Victorian building and transformed it into a modern, fit for purpose, shopping area.

Most people will have seen the new brightly coloured indoor market but you may not be aware that work on the building's historic upper storeys amounted to around £2 million of the total £4 million cost.

The first and second floors hold 20 offices, which have now all been let to a variety of businesses at commercial rates. This has not only provided them with modern office space in an excellent town centre location but has also provided the council with much-needed rental income.

Significant work was also carried out on one of the town's hidden jewels, situated on the first floor of the building: the Assembly Rooms.

The Market Hall and Assembly Rooms opened in 1857, designed by local architects Davies and

*The newly refurbished Assembly Rooms*

Tew, and have been in constant use ever since.

The redevelopment of the building was partly funded by a grant from the European Regional Development Fund and through Heritage Lottery funding.

It enabled the rooms to be restored to their Victorian glory while retaining historical features.

This included a full redecoration, new lighting, work to the external façade, work carried out to the ceiling, and polishing the original floor – restoring it to its former appearance.

The rooms include two stained glass windows showing the common seal of the borough of Chesterfield, complete with fleur de lis and pomegranates split open revealing their seeds – a symbol of fertility.

The original tiles on the walls have been restored and cleaned, while repainting of the ceiling has

included gold edging of the timber cornice.

The Assembly Rooms now have their own dedicated entrance at ground level – something they didn't have before, which will allow people attending events in the venue to head straight up to the rooms without having to go through the Market Hall.

They also have full disabled access with a new lift installed together with new toilet facilities.

The fabric of the Assembly Rooms has been improved with new curtains, chairs and tables.

The Assembly Rooms, together with two smaller meeting rooms, are available to hire through Chesterfield Venues.

Since re-opening, the Assembly Rooms have hosted the CAMRA beer festival, the children's theatre show *The Night Before Christmas* and breakfast meetings held by Destination Chesterfield.



*Photo courtesy of Destination Chesterfield*

Chesterfield Venues are also responsible for the hire of other buildings owned by the council, including the Pomegranate Theatre, the Winding Wheel and Hasland Village Hall.

**See page 23 for details or visit [www.chesterfieldvenuehire.co.uk](http://www.chesterfieldvenuehire.co.uk)**



*Market Hall interior*

**Chesterfield Assembly Rooms are on the first floor of Chesterfield Market Hall, in the Market Place.**

**The Assembly Rooms comprise a hall that can seat up to 135 people, licensed for a maximum of 200, and two smaller meeting rooms which can hold between 20 and 45 people each.**

**The Assembly Rooms are suitable for meetings, conferences, wedding receptions, parties or dances.**

**Hirers can also use a kitchen facility and the balcony overlooking the sale hall as a break out area.**

**Catering can be provided on site by Market Plaza Café or a list of caterers, bar and disco hire can be provided on request.**

**For more, call 01246 345333 or e-mail: [venuehire@chesterfield.gov.uk](mailto:venuehire@chesterfield.gov.uk)**

# All in one place

**Chesterfield residents will soon benefit from help and advice from four voluntary sector organisations all in the one place.**

**Derbyshire Unemployed Workers Centre, Chesterfield Law Centre and the Trade Union Safety Team will move into the basement of the Town Hall, Rose Hill on 12 April, with Links CVS joining them from 1 May.**

**They will occupy roughly half the basement offices around the old housing services reception.**

**Changes have been made to convert offices into interview rooms and create modern open plan work spaces.**

**The organisations will be able to reduce their operating costs by sharing facilities, knowledge and resources.**

● **We will feature more about this work in our next edition once they have moved in.**

## Derbyshire adopts Chesterfield anti-social behaviour scheme

**A scheme to protect victims of anti-social behaviour, which was trialled in Chesterfield, is being rolled out across Derbyshire.**

The new IT system, called ECINS, was introduced in Chesterfield in April last year. It allows partners including Chesterfield Borough Council and Derbyshire Constabulary to share information about anti-social behaviour quickly and effectively.

The system records all live cases and allows each officer dealing with anti-social behaviour to track cases, support victims and record action taken against people committing the crime.

Derbyshire Constabulary has seconded an officer to the Chesterfield Community Safety Partnership to support staff dealing with anti-social behaviour cases.

It was introduced after the suicide of Fiona Pilkington and the killing of her daughter, Frankie Hardwick, in Leicestershire in 2007.

The inquest into their deaths in 2009 found that the police and local councils had contributed by not co-ordinating more than 30 reports of anti-social behaviour against them.

The scheme was introduced in Amber Valley and North East Derbyshire late last year and will be adopted across the county in the coming months.



## Check your bin collection online

If you're not sure when your next bin collection is due, you can check online with a brand new feature on our website.

Simply visit [www.chesterfield.gov.uk/bindates](http://www.chesterfield.gov.uk/bindates) and enter your street name into the box on the screen and your collection dates will be displayed for up to the next 10 weeks.

The information is kept up to date and will include any disruption to collections over the Easter holiday period.

# New sprinklers for Catherine Court

**Residents at the Catherine Court sheltered housing complex, off Chatsworth Road, have benefited from a new sprinkler system to improve fire safety.**

The new domestic sprinklers have been funded jointly by Chesterfield Borough Council and Derbyshire Fire and Rescue Service.

Catherine Court is the latest in a programme of works by the council to improve fire safety at its premises. This has seen new smoke alarms, fire doors, roof compartments and sprinkler systems installed.

## Transforming Hornsbridge

**Work is set to begin in May to transform a key gateway into Chesterfield town centre.**

Hornsbridge roundabout is the main route into the town from the M1 and is also seen by passengers entering and leaving Chesterfield by train.

Chesterfield residents and business leaders chose the design, 'Growth' by Derbyshire based artist Melanie Jackson to brighten up the site.

The design features a wheel, or

cog, integrated into the landscape symbolising our borough's strong industrial heritage with an opening bud or flower rising out of the centre with eight petals.

Melanie is in discussions with local engineering firms to make the sculpture.

Work will begin on site in May and will be finished by the end of the year.

The project has been funded by the European Regional Development Fund and Barratt Homes. This funding can only be used to make environmental improvements and install public art at key sites and entry points to the town centre.

Proposals for the second phase of gateway enhancements are currently being developed for the approach to Chesterfield Railway Station.



# Your Chesterfield What's on

## Chesterfield events



Saturday 12 April to Saturday 31 May

### The Vikings are coming!

Chesterfield Museum  
An interactive exhibition about life in Viking times.

The museum is open Monday, Thursday, Friday and Saturday from 10am to 4pm.

Admission is free.  
Tel: 01246 345727



Friday 18 April  
**Revolution House**  
11am to 4pm.

Good Friday opening. Then the thatched cottage which played a key part in 17th century history will be open each Saturday and Sunday until 28 September.

Admission is free.  
Tel: 01246 345727

Thursday 24 April  
**Viking Day**  
10am to 4pm  
Chesterfield Museum  
An interactive event suitable for all ages.  
Tel: 01246 345727

Sunday 15 June  
**Race for Life**  
10.30am  
Town Hall, Rose Hill, ending in Queen's Park  
To enter, visit: <http://raceforlife.cancerresearchuk.org>

## Chesterfield Venues



BOX OFFICE 01246 345222

Every Tuesday  
**Ballroom Dancing**  
7.30pm to 10.30pm



Tuesday 1 April  
8pm

### Omid Djalili Live

"Right now, the Iranian Djalili is probably one of the most subversive, let alone funniest, comedians around"  
The Guardian

Wednesday 2 April  
7.30pm

### Charlie Landsborough Spring Tour 2014

Charlie and his band take to the road again as a sequel to his successful 2013 tour.

Friday 4 April  
7.30pm

### Psychic Sally Morgan

An ordinary woman with an extraordinary gift.

Saturday 5 April  
8pm

### Northern Soul and Motown Night

Soul over easy are back with another two-roomed Soul Night.

Sunday 6 April  
5.45pm doors, 6.30pm start

### The Final Curtain

The final concert from the Chesterfield Charity Committee, who intend to go out with a bang.

Wednesday 9 April  
7.30pm

### The Fureys and Davey Arthur

Legends of Irish music and song who have been entertaining with folk/middle of the road songs for 35 years.



Thursday 10 April  
7.30pm

### Gerry Cross the Mersey

An Evening with Gerry and the Pacemakers

Friday 11 April  
7.30pm

### Paul Carrack

Paul is back with his Sheffield-based band playing songs from his vast catalogue.

Saturday 12 April  
8pm to 11.30pm

### Ballroom Dancing

50/50 mix of ballroom and sequence dancing to live music.

Sunday 13 April  
7.30pm

### Billy Pearce

A hilarious night of adult comedy from one of Britain's most talented and best loved comedians.

Thursday 17 April  
7.30pm

### We Say Yeah: Cliff through the Years

Featuring Steve Halliday as Cliff and The Undercover Shadows bringing the sounds of The Shadows to the stage.

Thursday 24 April  
7.15 doors, 8pm start

### Spotlight Comedy Club

Comedians Steve Harris and Peter Brush share the stage with Compere Anthony J Brown.

Friday 25 April  
8pm

### Lovin' the 70s

Fancy dress is not obligatory but highly recommended.



BOX OFFICE 01246 345222



Tuesday 1 April  
7.30pm

### Film:

**Behind the Candelabra (15)**  
About the secret relationship of Liberace and Scott Thorson

Wednesday 2 April  
7.30pm

### The Only Way is Downton

Presented by Seabright Productions.

Culture clashes and eras hilariously collide in the brilliant new parody.



Thursday 3 April  
7.30pm

### Honor Blackman

In conversation with Director Richard Day, she looks back on her astonishing life.

Friday 4 April  
7.30pm

### Voice of the Heart: Karen Carpenter

Superb vocals from Carole Gordon celebrate the music of the Carpenters.

Saturday 5 April 6pm and  
Sunday 6 April 1pm and 6pm  
**The Sleeping Beauty and  
Got to Dance**

Talented young dancers from tot to young adult come together to perform the enchanting story of Sleeping Beauty.

Monday 7 April  
7.15pm doors, 8pm start  
**Djanganauts**

A fresh modern sound but firmly rooted in the style of the legendary Manouche guitar virtuoso Django Reinhardt.

Tuesday 8 April  
7.30pm

### **Kissing Sid James**

Presented by Reform Theatre Company in association with Harrogate Theatre. "You know a true comic playwright when the audience start



laughing before the actors tell jokes"  
\*\*\*\*\* *The Guardian*.

Wednesday 9 April  
7.30pm

**Mike McGear McCartney**  
Mike takes you through his family album, with stories of Liverpool life from childhood to entering showbiz.

Monday 14 to Saturday 19  
April  
6.30pm

### **Love 2 Dance**

Presented by  
The Academy of Dance.

An extravaganza of colour and dance genres, including the traditional finale of Academy Show Girls.



Thursday 24 April  
7.30pm

### **Tony Bennett the Show**

With visuals, music and narration 'Bennett' tells the captivating story of the rise and rise of Anthony Dominick Benedetto.

Friday 25 April  
7.30pm

### **The Pop Factor**

This electric show pays tribute to all your favourite songs and stars from the charts.

Saturday 26 April  
7.30pm

### **A Feast of Gilbert and Sullivan**

Presented by Much Loved Productions. The UK's No1 Gilbert and Sullivan Concert with former singers of The D'Oyly Carte Opera Company.

Tuesday 29 April to Saturday  
3 May

7.15pm, Saturday Matinee  
2.15pm

### **Me and My Girl**

Presented by Chesterfield Operatic Society.

Thursday 8 May  
7.30pm

### **Vamos: Finding Joy**

Vamos Theatre is delighted to present its 2014 full mask touring production.



## Chesterfield Venue Hire

Chesterfield Venues are elegant locations for any event. With rooms accommodating groups of 20 to 900 people in four of Chesterfield's iconic locations, the Winding Wheel, Pomegranate Theatre, The Assembly Rooms and Hasland Village Hall.

- Wedding ceremonies
- Wedding receptions
- Parties
- Award ceremonies
- Banquets
- Concerts
- Theatrical performances
- Conferences
- Exhibitions
- Meetings
- Presentations
- Dances
- Lectures

All rooms have their own private bar and catering facilities. An in-house catering service is available from buffets to silver service dinners or kitchen hire is available for your own catering. Our facilities boast a five star hygiene rating. Most of the rooms are fully accessible, with a lift serving upper floors. Chesterfield Venues offers a selection of Chesterfield's most unique properties to hire. The venues are owned and managed by Chesterfield Borough Council, offering excellent value for money and the freedom to have your event tailored to your needs.

For more details please call **01246 345 333**  
email [venuehire@chesterfield.gov.uk](mailto:venuehire@chesterfield.gov.uk)  
or visit [chesterfieldvenuehire.co.uk](http://chesterfieldvenuehire.co.uk)

Chesterfield  
Venues

